

# 2 1/2" DRIVE SOCKETS & ATTACHMENTS

## 6 Point - Deep Length - Impact Black Industrial Finish

Hex Size	6 Point Part No.	Overall Length in. a	Drive End in. b	Hex End in. c	Taper Length in. d	Bolt Clearance in. e
37/16"	9-6110L	7.75	5.00	5.25	.81	2.50
3 1/2"	9-6112L	7.75	5.00	5.37	.81	2.50
3 5/8"	9-6116L	8.00	5.00	5.50	.81	2.62
3 3/4"	9-6120L	8.00	5.00	5.68	.81	2.75
3 7/8"	9-6124L	8.25	5.00	5.90	.81	2.75
4"	9-6128L	8.25	5.00	6.00	.81	3.00
4 1/8"	9-6132L	8.50	5.00	6.12	.81	3.00
4 1/4"	9-6136L	8.75	5.00	6.25	.81	3.00
4 3/8"	9-6140L	8.75	5.00	6.50	.81	3.25
4 1/2"	9-6144L	9.00	5.00	6.62	.81	3.25
4 5/8"	9-6148L	9.00	5.00	6.75	.81	3.25
4 3/4"	9-6152L	9.25	5.00	6.87	.81	3.50
4 7/8"	9-6156L	9.50	5.00	7.00	.81	3.50
5"	9-6160L	9.75	5.00	7.25	.81	3.50

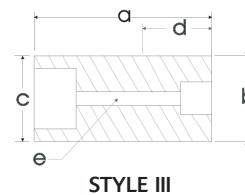
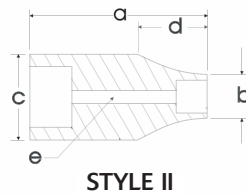
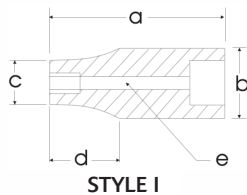

## # 5 Spline Drive Standard Length Impact - Black Industrial Finish



Hex Size	6 Point Part No.	Overall Length in. a	Drive End in. b	Hex End in. c	Taper Length in. d	Bolt Clearance in. e	
1 1/8"	9-036	3.15	2.17	1.89	1.38	1.06	I
1 1/4"	9-040	3.15	2.17	2.17	—	1.18	II
1 5/16"	9-042	3.15	2.17	2.17	—	1.26	
1 7/16"	9-046	3.15	2.17	2.36	0.94	1.34	
1 1/2"	9-048	3.15	2.17	2.36	0.94	1.42	
1 5/8"	9-052	3.15	2.17	2.64	1.04	1.54	
1 11/16"	9-054	3.15	2.17	2.64	1.04	1.54	
1 13/16"	9-058	3.86	2.56	2.87	1.18	1.73	
1 7/8"	9-060	3.86	2.56	2.87	1.18	1.77	
2"	9-064	3.86	2.56	3.11	1.18	1.81	
2 1/8"	9-068	3.86	2.56	3.11	1.18	1.93	
2 3/16"	9-070	3.86	2.56	3.27	1.18	1.99	
2 1/4"	9-072	4.17	2.56	3.39	1.18	2.05	
2 5/16"	9-074	4.17	2.56	3.39	1.18	2.11	
2 3/8"	9-076	4.17	2.56	3.39	1.18	2.17	
2 9/16"	9-082	4.61	3.39	3.90	1.18	2.36	
2 3/4"	9-088	4.61	3.39	3.90	1.18	2.56	Style III